



| DRAW WIRE SENSOR, CDB RANGE

Product Description

CDB Potentiometer draw-wire sensor offer a simple and cost effective solution to measure linear movement. These sensors do not need to be precisely guided and are especially adapted for heavy duty applications:



- Industrial solution,
- High accuracy,
- Adapted to harshest environments,
- Compact conception,
- Friendly user installation
- High Ingress Protection : IP67,
- Measuring range from 0 to 700mm,
- Recyclable noble material use (RoHS),
- Usinage dans la masse,
- Drum mounted on ball bearings,
- Used rotary sensor: multi-turn potentiometer,
- Almost-infinite resolution (in function of subsequent electronic).



SPECIFICATIONS

Characteristics

Range	0 to 700mm
Cable Material	Stainless Steel
Housing	Aluminum (RoHS)
Cable Diameter	1mm
Cable Tension	7N (Standard 700mm range)
Speed	5 m.s ⁻¹
Max Acceleration	20 m.s ⁻²
Weight	1 500g
Operating Temperature	-10 to +120°C
Storage Temperature	-20 to +125°C
IP (EN 60529)	IP67

Connection

Pinouts	Function
A	+Vcc
B	Signal +
C	GND Power Supply
D	NC
E	NC
F	NC

Mating Female Connector — Soldering Side

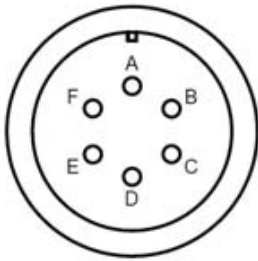

Electronics

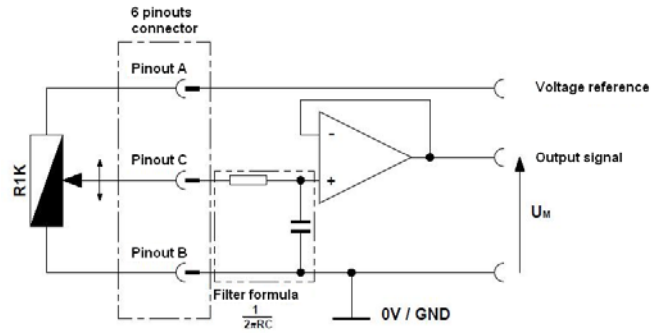

Output Signal Diagram

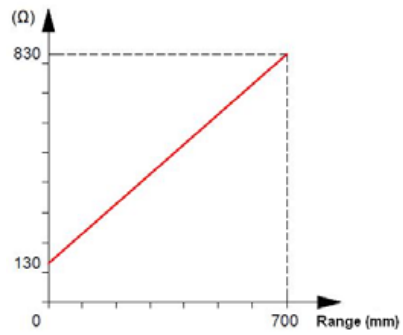



DIMENSIONS

Dimensions in mm

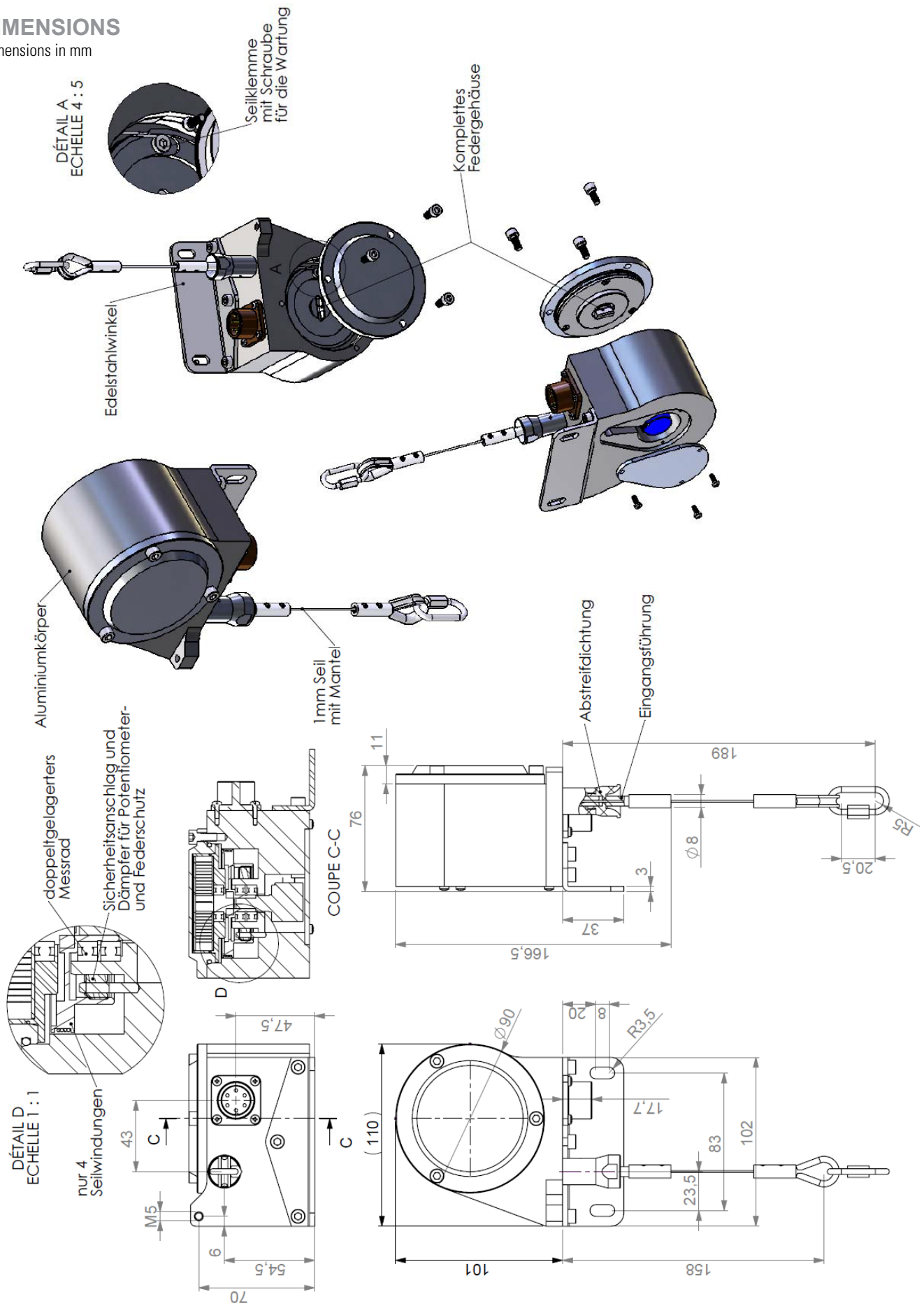



ORDERING OPTIONS

Series	CDB	800	0	700	ROOK	L20	C
Range							
800: 800mm							
Measure Origin (mm)							
Full Scale End (mm)							
Output							
130 to 830 Ohms							
Linearity							
±0.20% Full Range							
Connection							
6 Pinouts Connector (DIN41524)							



AGENCY APPROVALS AND CERTIFICATIONS



Sensata Technologies, Inc. ("Sensata") data sheets are solely intended to assist designers ("Buyers") who are developing systems that incorporate Sensata products (also referred to herein as "components"). Buyer understands and agrees that Buyer remains responsible for using its independent analysis, evaluation and judgment in designing Buyer's systems and products. Sensata data sheets have been created using standard laboratory conditions and engineering practices. Sensata has not conducted any testing other than that specifically described in the published documentation for a particular data sheet. Sensata may make corrections, enhancements, improvements and other changes to its data sheets or components without notice.

Buyers are authorized to use Sensata data sheets with the Sensata component(s) identified in each particular data sheet. HOWEVER, NO OTHER LICENSE, EXPRESS OR IMPLIED, BY ESTOPPEL OR OTHERWISE TO ANY OTHER SENSATA INTELLECTUAL PROPERTY RIGHT, AND NO LICENSE TO ANY THIRD PARTY TECHNOLOGY OR INTELLECTUAL PROPERTY RIGHT, IS GRANTED HEREIN. SENSATA DATA SHEETS ARE PROVIDED "AS IS". SENSATA MAKES NO WARRANTIES OR REPRESENTATIONS WITH REGARD TO THE DATA SHEETS OR USE OF THE DATA SHEETS, EXPRESS, IMPLIED OR STATUTORY, INCLUDING ACCURACY OR COMPLETENESS. SENSATA DISCLAIMS ANY WARRANTY OF TITLE AND ANY IMPLIED WARRANTIES OF MERCHANTABILITY, FITNESS FOR A PARTICULAR PURPOSE, QUIET ENJOYMENT, QUIET POSSESSION, AND NON-INFRINGEMENT OF ANY THIRD PARTY INTELLECTUAL PROPERTY RIGHTS WITH REGARD TO SENSATA DATA SHEETS OR USE THEREOF.

All products are sold subject to Sensata's terms and conditions of sale supplied at www.sensata.com SENSATA ASSUMES NO LIABILITY FOR APPLICATIONS ASSISTANCE OR THE DESIGN OF BUYERS' PRODUCTS. BUYER ACKNOWLEDGES AND AGREES THAT IT IS SOLELY RESPONSIBLE FOR COMPLIANCE WITH ALL LEGAL, REGULATORY AND SAFETY-RELATED REQUIREMENTS CONCERNING ITS PRODUCTS, AND ANY USE OF SENSATA COMPONENTS IN ITS APPLICATIONS, NOTWITHSTANDING ANY APPLICATIONS-RELATED INFORMATION OR SUPPORT THAT MAY BE PROVIDED BY SENSATA.

Mailing Address: Sensata Technologies, Inc., 529 Pleasant Street, Attleboro, MA 02703, USA.

CONTACT US

Americas
+1 (800) 350 2727 – Option 1
sales.beisensors@sensata.com
Europe, Middle East & Africa
+33 (3) 88 20 8080
position-info.eu@sensata.com
Asia Pacific
sales.isasia@list.sensata.com
China +86 (21) 2306 1500
Japan +81 (45) 277 7117
Korea +82 (31) 601 2004
India +91 (80) 67920890
Rest of Asia +886 (2) 27602006
ext 2808